

Linear fittings

Fluorescent fitting with easy disconnect

EVS - Zones 1, 2 & 21, 22



Features

- Easy disconnect without wiring to remove the gear tray
- All components mounted on hinged and removable gear tray for easy maintenance
- Double central locking for ingress protection
- Automatic switch off on opening
- Including accessories (cable gland, plugs & fixing brackets)

Specifications

- Main body constructed of glass reinforced polyester for high impact strength
- UV protected polycarbonate diffuser to resist harsh environments
- Rated voltage 220 - 240Vac/Vdc 50-60Hz
- EOL (End of life) the ballast prevents the lamp cap at the end of lamp life cycle from overheating
- Instant start
- Wiring configuration: 5 wires
- 3xEntries M20
- 2x Emergency versions (Type: "EM" version 3h battery duration or "EMA" with 3h with automatic test and blackstart capabilities)



Certifications



Standards

Approved to:	EN 60079-0 (General requirements) EN 60079-1 (Flameproof enclosure "d") EN 60079-31 (Enclosure "t") EN 60079-7 (Increased safety "e")
EC Type examination certificate to:	Directive 94/9/EC - (2014/34/UE) LCIE 11 ATEX 3065X IEC Ex LCI 11.0053X Ex II 2 G Ex de IIC T4 Gb for -40°C to +60°C Ex II 2 D Ex tb IIIC T85°C Db IP66 for -40°C to +60°C
EMC Directive (2004/108/CE) - April 2016 (2014/30/UE)	EN 55015 : Conducted emission test and radiated emission test EN 61547 : CEM immunity EN 61000-3-2 : Harmonic current Emissions Class C EN 61000-3-3 : Limitation of voltage changes and flickers
Low voltage Directive (2006/95/CE) - April 2016 (2014/35/UE)	EN 60598-1 : Luminaire general requirements and tests, including dielectric strength and isolation resistance
Glow wire test:	960°C
Operating temperature:	-20°C to +55°C EVS, -10°C to +50°C EVS EM & EVS EMA
IP test:	IP66 IEC 60529
Impact protection index:	IK09 according to IEC 62262

Linear fittings

Fluorescent fitting with easy disconnect

EVS - Zones 1, 2 & 21, 22



3

EVS

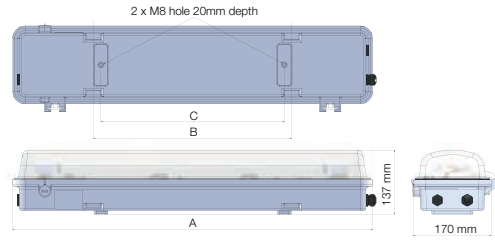

Dimensional drawing

Technical specifications

Type - For		Wiring Configuration	Light Rating W	Current A @ 230V	Dimensions mm			Weight kg
non armored cable	armored cable				A	B	C	



5 wires: Equipped with 1 cable gland & 2 plugs

EVS120-0000	EVS120-D000	5 wires*	1 x 18	0.09	785	432	400	5.81
EVS140-0000	EVS140-D000	5 wires*	1 x 36	0.17	1 370	900	700	8.60
EVS165-0000	EVS165-D000	5 wires*	1 x 58	0.26	1 670	900	700	10.40
EVS220-0000	EVS220-D000	5 wires*	2 x 18	0.17	785	432	400	5.81
EVS240-0000	EVS240-D000	5 wires*	2 x 36	0.33	1 370	900	700	8.60
EVS265-0000	EVS265-D000	5 wires*	2 x 58	0.5	1 670	900	700	10.40



5 wires through: Equipped with 2 cable glands & 1 plug

EVS120-B000	EVS120-E000	5 wires through**	1 x 18	0.09	785	432	400	5.81
EVS140-B000	EVS140-E000	5 wires through**	1 x 36	0.17	1 370	900	700	8.60
EVS165-B000	EVS165-E000	5 wires through**	1 x 58	0.26	1 670	900	700	10.40
EVS220-B000	EVS220-E000	5 wires through**	2 x 18	0.17	785	432	400	5.81
EVS240-B000	EVS240-E000	5 wires through**	2 x 36	0.33	1 370	900	700	8.60
EVS265-B000	EVS265-E000	5 wires through**	2 x 58	0.5	1 670	900	700	10.40

Note. * For armored cable with continuity plate ** For armored cable with 2 continuity plates

Technical information

<p>Lamps Fluorescent Lamp (order separately) T8 bi-pin tube, lampholder G13, diameter 26mm - white industry 4 000°K.</p> <p>CRI 80</p> <p>Photometric curve See page 6/9</p> <p>Rated voltages Electronic ballast: 220-240Vac/Vdc 50/60Hz. EOL (End of life) the ballast prevents the lamp cap at the end of lamp life cycle from overheating</p>	<p>Dielectrical class I</p> <p>Grounding system TNS, TNC, TT, IT neutral system</p> <p>Power factor 0.98.</p> <p>Terminal block (spring) Jumped bar x2 terminal blocks 4mm² (rigid wire), 2.5mm² (flexible wire) Terminals supplied L1, L2, L3, N, PE (looping possible with one additional cable gland)</p>	<p>Cable entries Three entries M20 For non- armored cable: included two M20 nylon plugs (EX-M20) and one M20 nylon cable gland, diameter 6-12mm (EXCGM20S) For armored cable: included continuity plate - two M20 nylon plugs (EX-M20) and one M20 nickel plated brass cable gland, diameter 6-12/ 8.5-16mm (EXN04MMC1)</p>	<p>Housing Fiberglass reinforced polyester housing for high impact strength, UV protected polycarbonate diffuser to resist harsh environments, Painted steel gear tray & Stainless steel 316L insert</p> <p>Fixing (included) V015 - 2x Two zinc-plated steel brackets for ceiling mounting (included with product)</p>
---	--	--	---

Linear fittings

Emergency Fluorescent fitting with easy disconnect - 3h EVS EM - Zones 1, 2 & 21, 22

Technical specifications

Type - For		Wiring Configuration	Light Rating W	Battery h	Current A @ 230V	Dimensions mm			Weight kg
non armored cable	armored cable					A	B	C	
3 wires: Equipped with 1 cable gland & 2 plugs									
EVS120EME-0000	EVS120EME-C000	3 wires*	1 x 18	3h	0.09	785	432	400	8.40
EVS140EM-0000	EVS140EM-C000	3 wires*	1 x 36	3h	0.17	1 370	900	700	11.02
EVS165EM-0000	EVS165EM-C000	3 wires*	1 x 58	3h	0.26	1 670	900	700	13.40
EVS220EME-0000	EVS220EME-C000	3 wires*	2 x 18	3h	0.17	785	432	400	8.40
EVS240EM-0000	EVS240EM-C000	3 wires*	2 x 36	3h	0.33	1 370	900	700	11.02
EVS265EM-0000	EVS265EM-C000	3 wires*	2 x 58	3h	0.50	1 670	900	700	13.40

Note. * For armored cable with continuity plate. For dimensional drawing please refer to page 3/4

Electrical Features

Lamps

Fluorescent Lamp (order separately)
T8 bi-pin tube, lampholder G13, diameter 26mm - white industry 4 000°K

Rated voltages

Electronic ballast: 220-240Vac/Vdc 50/60Hz
EOL (End of life) the ballast prevents the lamp cap at the end of lamp life cycle from overheating.

Power factor

0.98.

Battery

Battery NiCd 7,2V
4Ah in flameproof case (Ex d)
Lumen output in emergency mode (1 lamp lit)
2 hours: 40% for EVS120, EVS220, 33% for EVS140, EVS240, 10% for EVS165, EVS265
3 hours: 24% for EVS120, EVS220, 18% for EVS140, EVS240, 8% for EVS165, EVS265
Monitored by one LED

Terminal block

Terminal block (screws plug in terminal block)
4mm² (rigid wire), 2,5mm² (flexible wire)
Terminals supplied L1, L2, L3, N, PE (looping possible with one additional cable gland)

Cable entries

Three entries M20
For non- armored cable: included two M20 nylon plugs (EX-M20) and one M20 nylon cable gland, diameter 6-12mm (EXCGM20S)
For armored cable: included continuity plate - two M20 nylon plugs (EX-M20) and one M20 nickel plated brass cable gland, diameter 6-12/ 8.5-16mm (EXN04MMC1)

Housing

Fiberglass reinforced polyester housing for high impact strength, UV protected polycarbonate diffuser to resist harsh environments
Stainless steel 316L insert
Painted steel gear tray

Fixing

V015 - 2x Two zinc-plated steel brackets for ceiling mounting (included with product)

Emergency function diagrams

Wiring provided by DTS - Maintained Mode

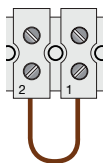

Switch between 1/2 - Non Maintained Mode *

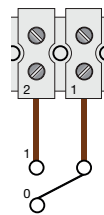

Mains Supply	Tube	Battery
ON	Lit	Charging
OFF	Only emergency tube lit	Discharging

Mains Supply	Tube	Battery
ON	OFF	Charging
OFF	Only emergency tube lit	Discharging

* This table corresponds to the position 0 "open".
If the switch is on position 1 "close", refer to the table on the left

Linear fittings

Emergency Fluorescent fitting with automatic test & blackstart capabilities. EVS EMA - Zones 1, 2 & 21, 22

Technical specifications

Type - For		Wiring Configuration	Light Rating W	Battery h	Current A @ 230V	Dimensions mm			Weight kg
non armored cable	armored cable					A	B	C	



5 wires: Equipped with 1 cable gland & 2 plugs

EVS120EMA-0000	EVS120EMA-D000	5 wires*	1 x 18	3h	0.09	785	432	400	8.80
EVS140EMA-0000	EVS140EMA-D000	5 wires*	1 x 36	3h	0.17	1 370	900	700	11.02
EVS220EMA-0000	EVS220EMA-D000	5 wires*	2 x 18	3h	0.17	785	432	400	8.80
EVS240EMA-0000	EVS240EMA-D000	5 wires*	2 x 36	3h	0.33	1 370	900	700	11.02

Note. * For armored cable with continuity plate. For dimensional drawing please refer to page 3/4

Electrical Features

Lamps

Fluorescent Lamp (order separately)
T8 bi-pin tube, lampholder G13, diameter 26mm - white industry 4 000°K

Rated voltages

Electronic ballast: 220-240Vac/Vdc 50/60Hz
EOL (End of life) the ballast prevents the lamp cap at the end of lamp life cycle from overheating

Power factor

0.98.

Battery

Battery NiCd 6V 4Ah in flameproof case (Ex"d") for EVS120, EVS220
Battery NiCd 6V 7Ah in flameproof case (Ex"d") for EVS140, EVS240
Lumen output in emergency mode (1 lamp lit)
3h: 40% for EVS120, EVS220
33% for EVS140, EVS240
Monitored by two LED

Terminal block (spring)

Jumped bar x2 terminal blocks
4mm² (rigid wire), 2,5mm² (flexible wire)
Terminals supplied L1, L2, L3, LS, N, E, BS (looping possible with one additional cable gland)

Cable entries

Three entries M20
For non- armored cable: included two M20 nylon plugs (EX-M20) and one M20 nylon cable gland, diameter 6-12mm (EXCGM20S)
For armored cable: included continuity plate - two M20 nylon plugs (EX-M20) and one M20 nickel plated brass cable gland, diameter 6-12/ 8.5-16mm (EXN04MMC1)

Housing

Fiberglass reinforced polyester housing for high impact strength, UV protected polycarbonate diffuser to resist harsh environments
Stainless steel 316L insert
Painted steel geartray

Fixing (included)

V015 - 2x Two zinc-plated steel brackets for ceiling mounting (included with product)

Emergency function diagrams

Wiring provided by DTS - Maintained Mode

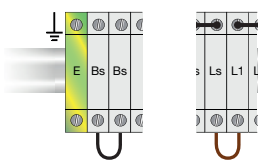

Switch between LS/L1 - Non Maintained Mode

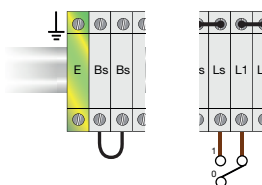

Mains Supply	Tube	Battery
ON	Lit	Charging
OFF	Only emergency tube lit	Discharged

Mains Supply	Tube	Battery
ON	OFF	Charging
OFF	Only emergency tube lit	Discharged

This table corresponds to the position 1 "closed".

Preventive maintenance mode

Battery charge - daily
Emergency lamp during 1min - weekly
Battery charge capacity during 1hr - quarterly
Clear system test display
Battery charge monitored by 2 LED

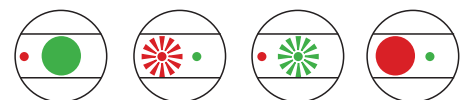

Healthy (test OK)
Emergency or Indicator Lamp Fault (must be replaced)
Test in Progress (waiting end of test)
Fault (replace battery)

Emergency function diagram - Blackstart mode

The EMA product contains 2 blackstart terminals. The **blackstart mode** consists in disconnecting the battery and so switching off the fitting. This mode is mainly used during maintenance. As soon as the maintenance is done, the main power ON and the blackstart terminals connected, the emergency fitting is ready to be used as the battery is not discharged.

Switch between BS terminals

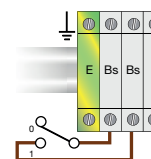

This table corresponds to the position 0 "open".

Mains supply	Tube	Battery
ON	Lit	Disconnected - not charged
OFF	OFF	Disconnected - not charged

Linear fittings

Accessories

EVS - Zones 1, 2 & 21, 22

Lamps

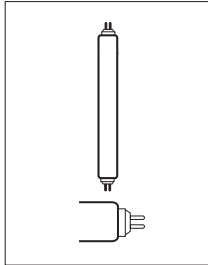

Bi-pin T8 fluorescent lamps

Specifications:

G13 - \varnothing 26mm
 Colour temperature: White industry 4 000°K
 CRI: > 80
 lm/W: 65 to 93
 Average operating life: 12 000 hours

Type	Power W	Lumen output lm	Lampholder
TL18W	18	1 250	G13
TL36W	36	3 350	G13
TL58W	58	5 200	G13

Fixing accessories*

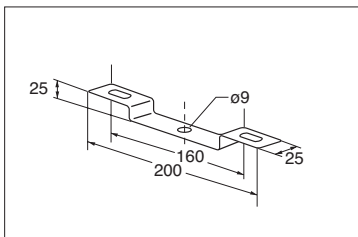

Brackets

Type	Specifications
V015	2 x pair of zinc plated steel for ceiling mounting (Included with product)
V016	stainless steel 316L brackets for ceiling mounting

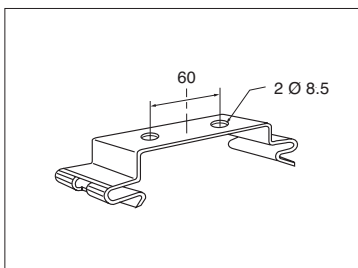

Mounting bracket clip

Type	Specifications
V014	2x Rapid ceiling mounting with stainless steel clip

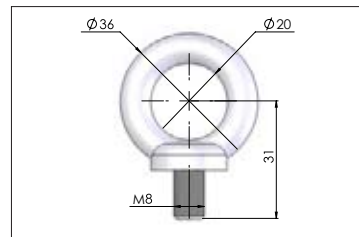

Hook

Type	Specifications
V024	2x Zinc plated steel suspension hook

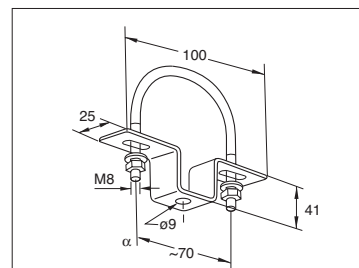

Fixing bracket and flange

Type	Specifications
V018	2x zinc plated steel pole mounted brackets for $\varnothing 1\frac{1}{4}$ & $1\frac{1}{2}$
V019	2x zinc plated steel pole mounted brackets for $\varnothing 2$ "
V021	2x Stainless steel 316L pole mounted brackets for $\varnothing 1\frac{1}{4}$ & $1\frac{1}{2}$
V022	2x Stainless steel 316L pole mounted brackets $\varnothing 2$ "

* Screws and locknuts supplied

Linear fittings

Spare parts

EVS - Zones 1, 2 & 21, 22

3

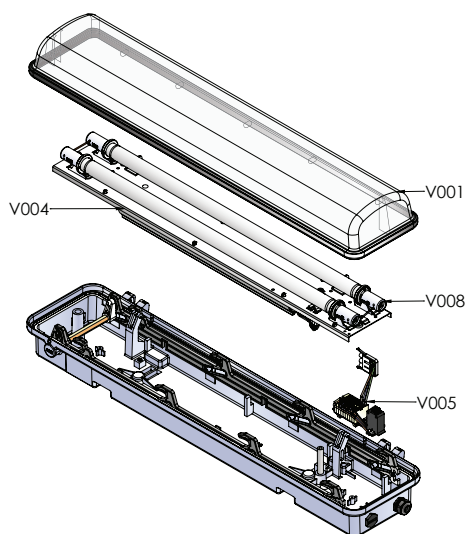

Spare parts

Type	Specifications
V00120W	20W diffuser with gasket for EV. range
V00140W	40W diffuser with gasket for EV. range
V00165W	65W diffuser with gasket for EV. range
V0041X20WS	Gear tray 1x18W with electronic ballast 220-240Vac/Vdc 50-60Hz for EVS120
V0041X40WS	Gear tray 1x36W with electronic ballast 220-240Vac/Vdc 50-60Hz for EVS140
V0041X65WS	Gear tray 1x58W with electronic ballast 220-240Vac/Vdc 50-60Hz for EVS165
V0042X20WS	Gear tray 2x18W with electronic ballast 220-240Vac/Vdc 50-60Hz for EVS220
V0042X40WS	Gear tray 2x36W with electronic ballast 220- 240Vac/Vdc 50-60Hz for EVS240
V0042X65WS	Gear tray 2x58W with electronic ballast 220- 240Vac/Vdc 50-60Hz for EVS265
V0041X20WEMS	Emergency gear tray 1x18W with electronic ballast 220-240Vac/Vdc 50-60Hz for EVS120EM
V0041X40WEMS	Emergency gear tray 1x36W with electronic ballast 220-240Vac/Vdc 50-60Hz for EVS140EM
V0042X20WEMS	Emergency gear tray 2x18W with electronic ballast 220-240Vac/Vdc 50-60Hz for EVS220EM
V0042X40WEMS	Emergency gear tray 2x36W with electronic ballast 220-240Vac/Vdc 50-60Hz for EVS240EM
V0041X65WEMS	Emergency gear tray 1x58W with electronic ballast 220-240Vac/Vdc 50-60Hz for EVS165EM
V0042X65WEMS	Emergency gear tray 2x58W with electronic ballast 220-240Vac/Vdc 50-60Hz for EVS265EM
V0041X20WEMAS	Emergency gear tray + auto test 1X18W with electronic ballast 220-240Vac/Vdc 50-60Hz for EVS120EMA
V0041X40WEMAS	Emergency gear tray + auto test 1X36W with electronic ballast 220-240Vac/Vdc 50-60Hz for EVS140EMA
V0042X20WEMAS	Emergency gear tray + auto test 2X18W with electronic ballast 220-240Vac/Vdc 50-60Hz for EVS220EMA
V0042X40WEMAS	Emergency gear tray + auto test 2X36W with electronic ballast 220-240Vac/Vdc 50-60Hz for EVS240EMA
V005S	Connection pack: XIN, terminal, track, connector
V008	Bi-pin G13 lampholder
V011	Battery pack Ni-Cd 7.2v -4Ah for EVS120EME, EVS220EME, EVS140EM, EVS240EM
V01120WEMEA	Battery for EVS120EMA, EVS220EMA
V01140WEMEA	Battery for EVS140EMA, EVS240EMA
V02520x40W	Brass continuity plate for EV. 120, EV. 220, EV. 140, EV. 240
V02565W	Brass continuity plate for EV. 165, EV. 265
EXCGM20S-01	Kit M20 Exe IIC nylon cable gland for non armoured cable diameter 6-12mm and locknut
EXN04MMC1-01	Kit M20 Ex-d IIC Ex-e II Ex-td double compression nickel plated cable gland for armoured cable diameter inner 6-12 outer 8.5-16mm locknut, sealing gasket