

26.5 GHz – Right Angle Cable Plugs (Male)

For semi-rigid cables

- With pin and isolator
- Centre contact plugged

Description	Item no.	Packaging	Cable group	Assembly instruction	Plating body	Fig.
16_SMA-50-2-100/199_NH	23018813	bulk 100 pcs.	Y3, Y11, Y16	27055	passivated stainless steel	1
16_SMA-50-3-100/199_NE	22648293	single	Y5, Y12, Y17	27055	passivated stainless steel	2

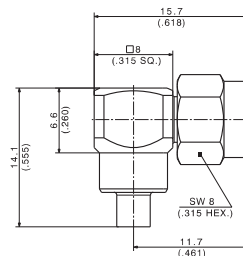

Fig. 1

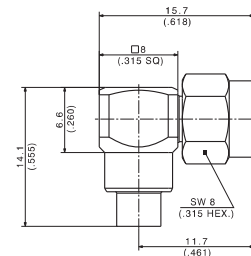

Fig. 2

Straight Cable Jacks (Female)

For semi-rigid cables

- Cable entry soldered
- Centre contact soldered

Description	Item no.	Packaging	Cable group	Assembly instruction	Plating body	Fig.
21_SMA-50-1-1/111_NE	22642385	single	Y19	9118	gold	1
21_SMA-50-1-2/111_NE	22642386	single	Y2, Y15	9119	gold	1
21_SMA-50-2-15/111_NE 21_SMA-50-2-15/111_NH	22544549 22652141	single bulk 100 pcs.	Y3, Y11, Y16	9057	gold	2
21_SMA-50-3-15/111_NE 21_SMA-50-3-15/111_NH	22544550 22645042	single bulk 100 pcs.	Y5, Y12, Y17	9057	gold	3

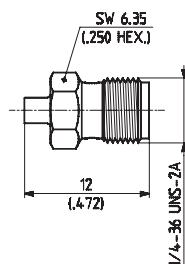

Fig. 1

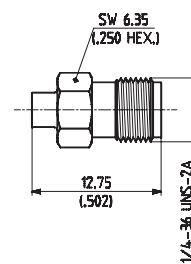

Fig. 2

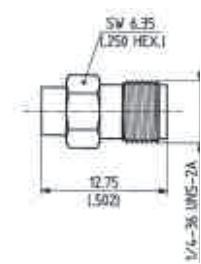

Fig. 3

Cable groups see page 34 ff.