

RWB

RWB-250R

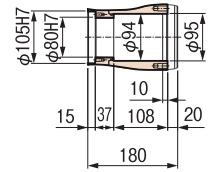

RWB-320R

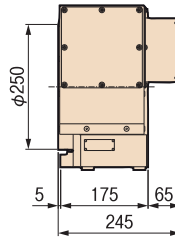
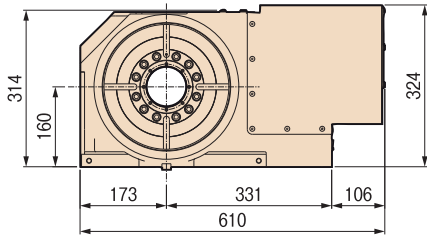
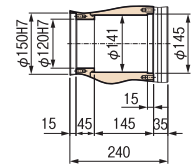
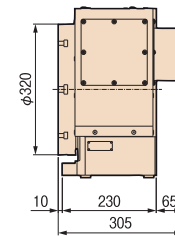
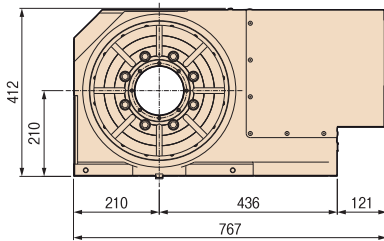

RWB-400R

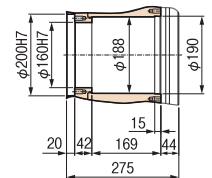
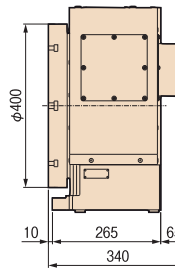
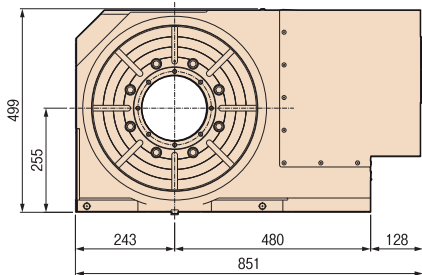

RWB-500R

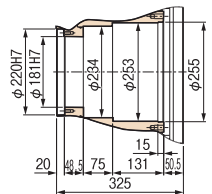
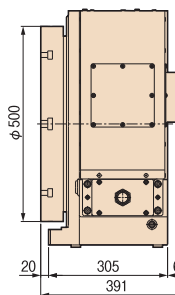
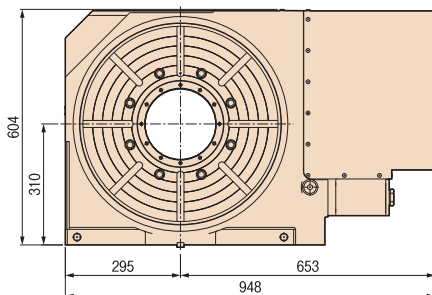

Alle oben angeführten Abmessungen beziehen sich auf FANUC Servomotoren!

Einheiten in mm

Spannpratzen / Spannbolzen

	Typ	Menge	T-Nuten-Abstand	T-Nuten-Breite	A	B	C	D	E	F	G	H	I	J	K	L	M
RWB-250	I	4	50~125	18	25	12	80	12	33	35	22	21	11	65	40	28	16
RWB-320	I	4	73~162	18	30	15	90	16	31	43	25	21	11	70	46	28	16
RWB-400	I	4	73~193	18	30	15	90	16	31	43	25	21	11	70	46	28	16
RWB-500	I	4	73~233	18	40	20	110	18	42	50	25	21	11	70	46	28	16

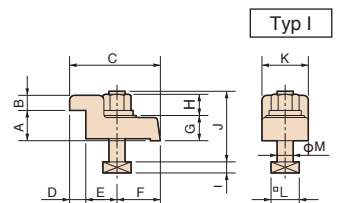

Wenn gesonderte Nutensteinausführungen / Spannpratzen benötigt werden, dann bitte diese bei TSUDAKOMA anfragen.